

Auckland Council  
**SUB60463130**  
 Approved by Delegated Officer  
 19/03/2026

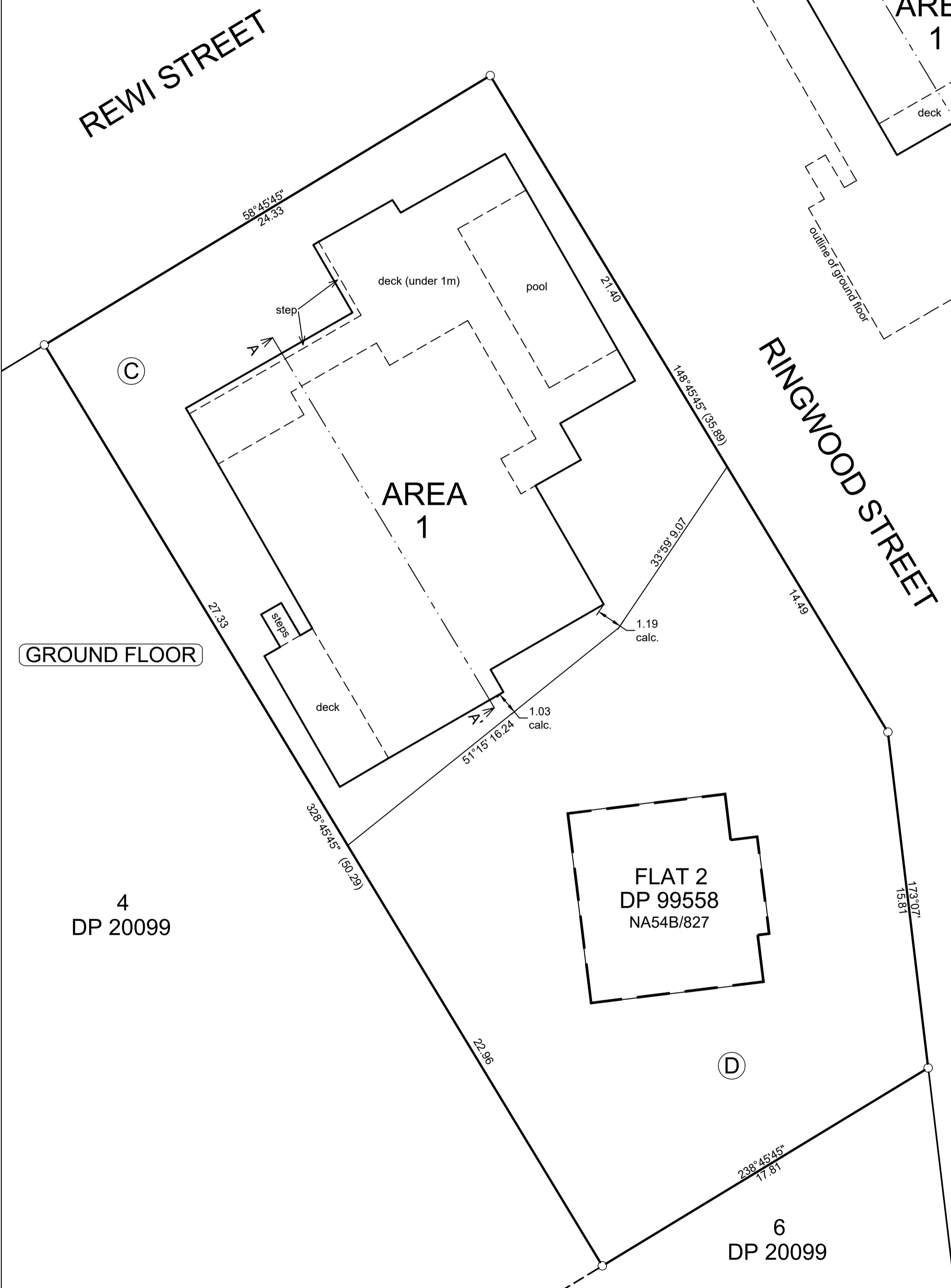
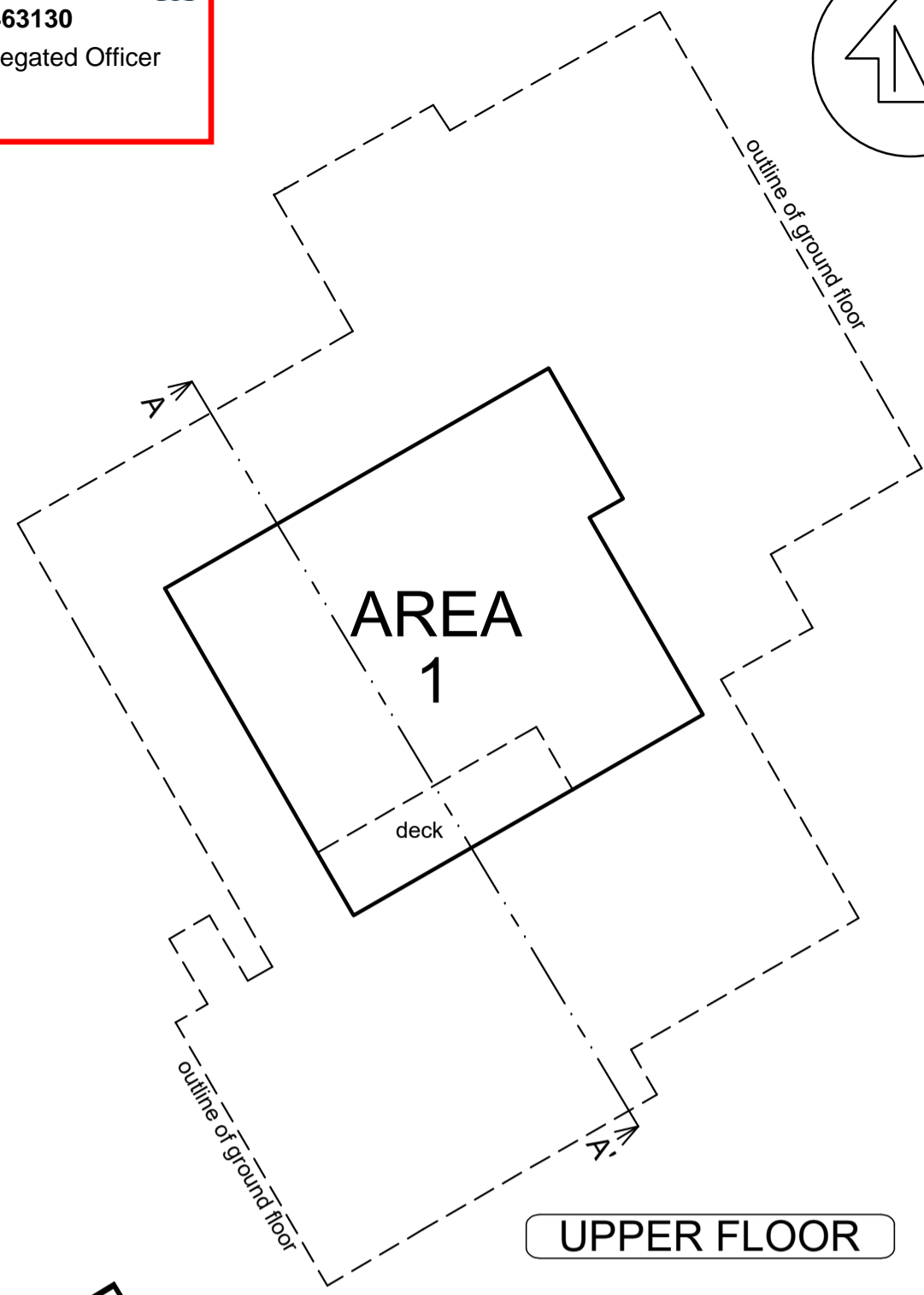
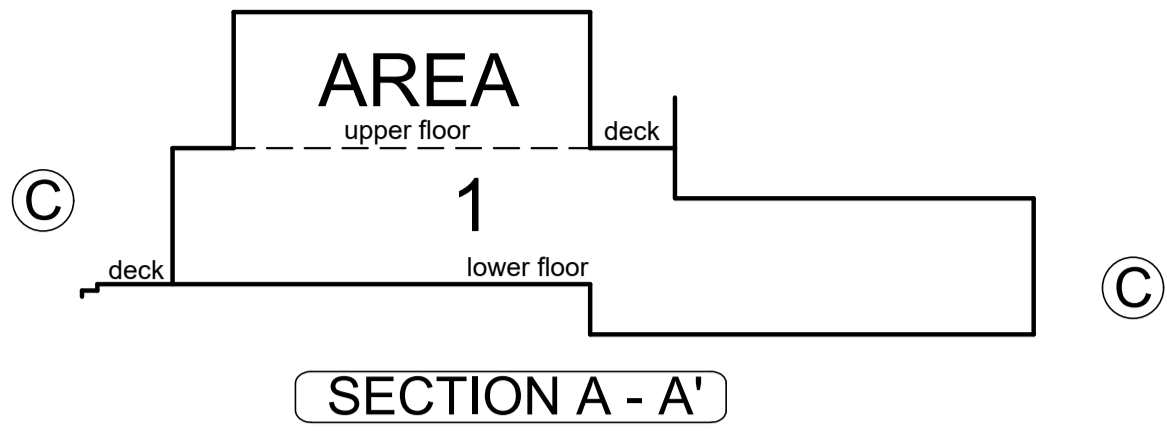
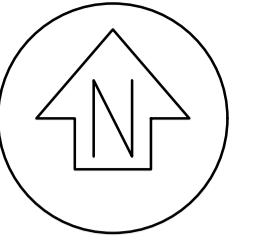

**AREAS 1, C & D ON LOT 5 DP 20099**

PREPARED BY:

**LAMB & ASSOCIATES LTD** (2018)  
 REGISTERED PROFESSIONAL SURVEYORS

#976 KAHIKATEA FLAT ROAD, WAITOKI  
 PH (09) 415 5919  
 email : lamb@surveyor.co.nz  
 www.surveyor.co.nz

**NOTES:**

- Areas C & D are to be subject to land covenants.
- Covenant boundaries follow outside faces of walls and structures unless otherwise shown.
- Unless otherwise shown covenant boundaries are not visibly defined.
- Unless otherwise shown peripheral lot bearings and dimensions have been adopted from DP 20099.
- Boundaries of Area 1 to be leased are to outside faces of walls and structures unless otherwise shown.

NEW RT ALLOCATED: AREA 1 - 1281568		COMPRISED IN - NA54B/826 & NA54B/827
TERRITORIAL AUTHORITY - AUCKLAND COUNCIL		LAND DISTRICT - NORTH AUCKLAND
SHEET 1 OF 1		SURVEYORS REFERENCE - 26031CH
DATE - FEB 2026 SCALE - 1:150 (A2)		<b>DP 627803</b>